

# 6334

## Soap Dispenser



# Installation

### Install soap dispenser

The plunger assembly, flange assembly, pump assembly and shank come pre-assembled but are shown unassembled for clarity.

1. Provide a 1-1/4" diameter hole in the deck at the location where the dispenser is to be installed.
2. Insert the square cut end of the supply tube through the shank and into the bottom of the pump assembly as shown.
3. Insert the shank with supply tube through the top of the hole in the deck and secure with the washer and wing nut provided.
4. Thread the soap bottle into the bottom of the shank.

### Fill and prime soap dispenser

The 6334 Soap Dispenser will dispense vegetable or coconut oil liquid soaps, synthetic detergents, and antiseptic solutions in a liquid form. A 10–15% concentration is recommended for vegetable or coconut oil liquid soaps. Synthetic detergents and antiseptic soaps require no dilution.

The soap bottle and shank are not removed when filling the dispenser.

After filling, the soap valve must be pumped several times to "prime" the unit, especially when it is filled for the first time.

1. Remove the plunger assembly:
  - Pull the plunger body upward and slide the wrench onto the flats on the flange assembly.
  - Rotate the wrench 1/4 turn counterclockwise to disengage the two locating pins securing the plunger assembly.
  - Pull the plunger assembly out of the flange.
2. Pour the liquid soap through the flange opening into the bottle up to the recommended fill level as shown.
3. Replace the plunger assembly:
  - Slide the wrench onto the flats on the flange assembly.
  - Insert the plunger assembly into the flange, aligning the two locating pins with the two grooves inside the flange.
  - Rotate the wrench 1/4 turn clockwise to engage the locating pins and secure the plunger assembly. Pull the plunger upward to ensure that it is locked into place.

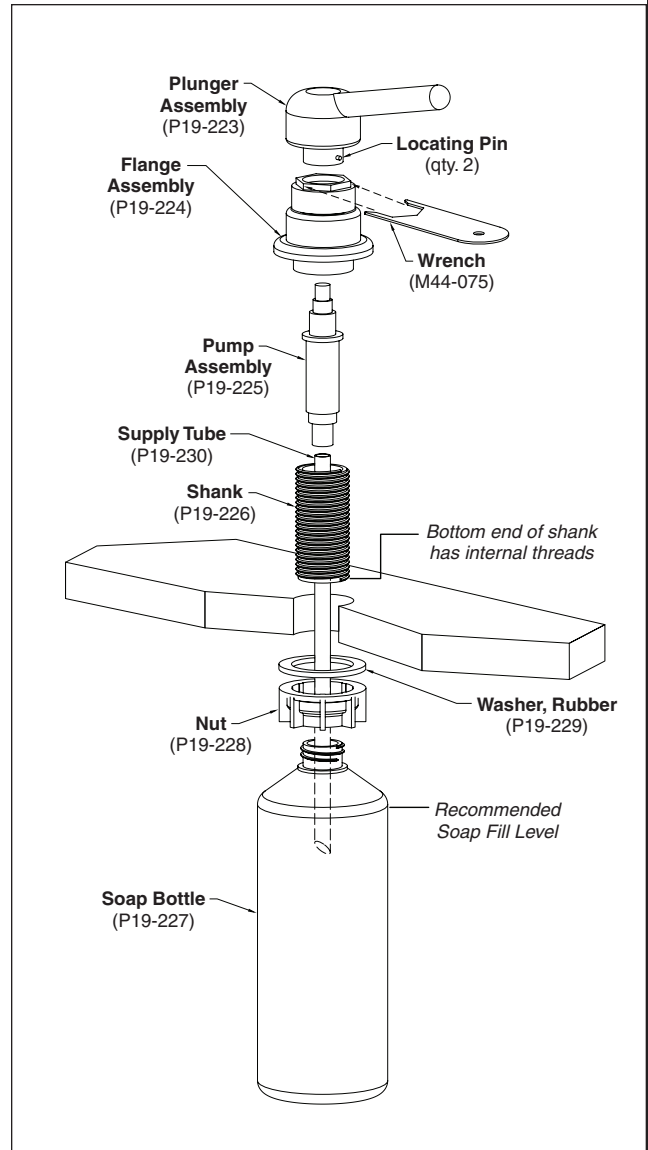

## Soap Dispenser Care and Maintenance

The 6334 Soap Dispenser will dispense vegetable or coconut oil liquid soaps, synthetic detergents, and antiseptic solutions in a liquid form. A 10–15% concentration is recommended for vegetable or coconut oil liquid soaps. Synthetic detergents and antiseptic soaps require no dilution.

Regular cleaning is advised for a soap dispenser in order that it may provide optimum performance and maximum service life. Cleaning the soap dispenser monthly to remove soap residue, dirt, and other accumulations should become a regular part of your washroom cleaning routine and general maintenance program.

### General Cleaning of Soap Dispenser

1. Use warm water and soap to clean the exterior of the soap dispenser. Do not use abrasive cleaners on the metal parts of the soap dispenser. Dry and polish with a soft cloth for a bright finish.
2. Inspect the interior of the soap bottle for residue or coagulation of soap. If residue or coagulation exists, clean the soap bottle. To clean the soap bottle,
  - pour out any remaining soap.
  - fill the bottle half full of hot water and shake well to dislodge the soap residue.
  - empty the water from the bottle.Repeat these three steps until the soap bottle is clean.
3. To clean the internal components of the soap dispenser, simply pump hot water through the soap dispenser until a clean flow of water comes out of the spout.

### Changing Soap Types

1. Unscrew the soap bottle from the shank and pour out all the remaining soap. Using hot water, rinse the bottle two or more times until all the residue is eliminated. In addition, pump the valve several times with hot water until a clear flow of water appears. Follow these steps with a rinse of ethyl alcohol (ethanol) and shake out thoroughly. Let the soap dispenser air dry.
2. After the dispenser is dry, reattach the soap bottle to the shank.
3. Unscrew the valve assembly from the shank using the wrench provided and withdraw it from the soap bottle.
4. Pour the liquid soap into the top opening of the shank.
5. Replace the valve assembly and tighten with the wrench provided.
6. Pump the soap valve several times to “prime” the unit.

### Soap Dispenser Maintenance

Because many of the problems with soap dispensers are caused by a build-up of soap residue, it is recommended that the internal components of the soap dispenser be cleaned periodically. To clean the soap dispenser components, follow the procedure outlined below:

1. Remove the plunger, flange and pump assemblies from the shank.
2. Clean the internal parts of the soap dispenser using hot water and a soft bristle brush.
3. Reassemble the soap dispenser.