

For Commercial and Industrial Applications

Job Name _____

Contractor _____

Job Location _____

Approval _____

Engineer _____

Contractor's P.O. No. _____

Approval _____

Representative _____

Series G4000 and G4000M1

2-piece, Full Port, Cast Iron Flanged Ball Valves

Sizes: 2" – 10" (50 – 250mm)**

Series G4000 and G4000M1 2-Piece, Full Port, Cast Iron Flanged Ball Valves feature a stainless steel ball and stem with 200psi (14 bar) CWP and 125psi (9 bar) WSP rating. These valves are ideal to replace old cast iron gate valves. The G4000M1 features reliable quarter-turn ball valve technology and the G4000 features a manual gear operator for positive shut-off.

Features

- 200psi (14 bar) CWP rating and 125psi (9 bar) WSP rating
- Same end-to-end dimensions as conventional flanged iron gate valves (ANSI 16.10)
- Quarter-turn open or close operation, sizes 8" - 10" and Manual gear operation
- Stainless steel ball and stem
- Positive shutoff
- 2-piece body construction
- FDA approved epoxy-coated valve available

Specifications

A 2-piece, full port, cast iron flanged ball valve to be installed as indicated on the plans. Approved valves shall comply with the American Standard for face-to-face dimensions (ANSI 16.10) for Class 125 iron flanged gate valves. The dimensions and drilling of end flanges shall conform to American Cast Iron Flange Standard, Class 125 (ANSI B16.1). Valves shall have stainless steel ball and stem. Plastic coated iron balls are not acceptable. Pressure rating no less than 200psi (14 bar) CWP and 125 (9 bar) WSP. The valve shall be a Watts Series G4000 or G4000M1.

Pressure – Temperature

Maximum Temperature: 353°F (178°C) for G4000M1 and 140°F (60°C) for G4000

Maximum Working Pressure: 200psi (14 bar) CWP;
125psi (9 bar) WSP



G4000M1 (2" - 6")



G4000

** Metric Dimensions are nominal pipe diameter. This product is produced with ASME/ANSI flanged end connections or DN flanged end connections.

Watts product specifications in U.S. customary units and metric are approximate and are provided for reference only. For precise measurements, please contact Watts Technical Service. Watts reserves the right to change or modify product design, construction, specifications, or materials without prior notice and without incurring any obligation to make such changes and modifications on Watts products previously or subsequently sold.

WATTS®

Materials

- | | |
|------------------------------|--------------------------------|
| 1. Body | Cast Iron, ASTM A126 Class B |
| 2. Ball | 304 Stainless Steel, ASTM A351 |
| 3. Seat | PTFE |
| 4. Stem | 304 Stainless Steel, AISI 304 |
| 5. Packing | PTFE |
| 6. Gland | Cast Iron, ASTM A126 Class B |
| 7. Gasket | PTFE |
| 8. Bolt and Nut | Steel, ASTM A6 |
| 9. Stop Plate | Steel Plated, ASTM A6 |
| 10. Stop Washer | Stainless Steel, AISI 304 |
| 11. Handle | Ductile Iron, ASTM A439 |
| 12. Hex Socket and Head Bolt | Steel, ASTM A6 |
| 13. Gear Operator | Cast Iron |
| 14. Handwheel | Ductile Iron |

Capacity

Valve Operating Torque – Ratings

SIZE		CV RATINGS	MAX. OPERATING TORQUE	
in.	mm**		in./lbs.	N-m
2	50	330	450	50.8
2½	65	420	620	70.0
3	80	600	750	84.7
4	100	1200	1420	160.4
6	150	3300	3190	360.4
8	200	9000	8860	1001.0
10	250	12400	10,630	1201.0

Dimensions – Weights

G4000M1

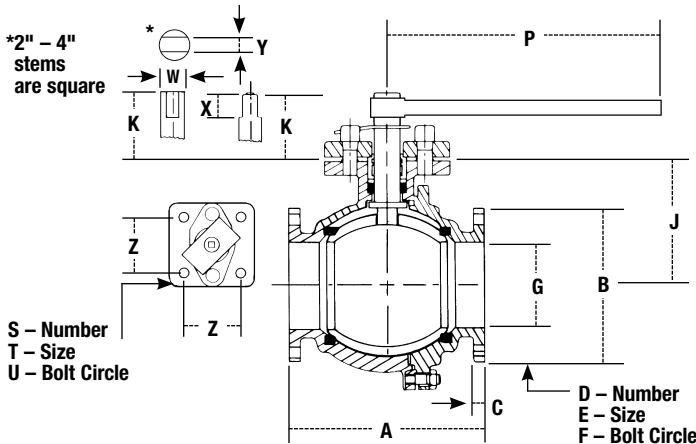

G4000

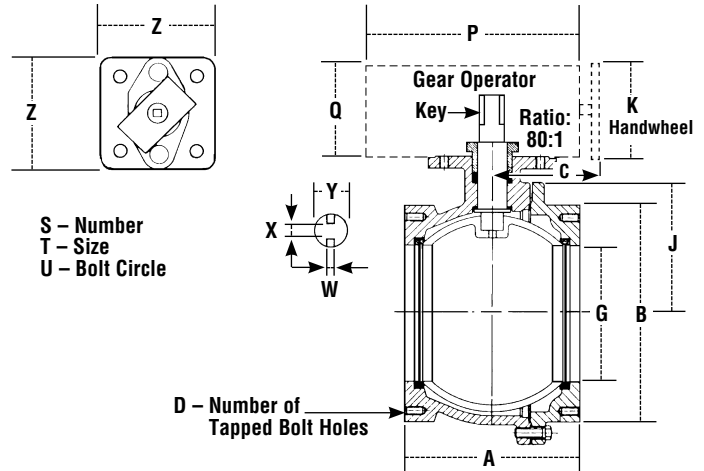

	SIZES (DN)**		DIMENSIONS																	WEIGHT
	A	B	C	D	E	F	G	J	K	P	Q	S	T	U	W	X	Y	Z		
G4000M1	in 2	7	6	5/8	4	3/4	4 3/4	2	3	2	9	-	4	1/2-13UNC	3/4	5/8	1	5/8	2 5/16	22.0 lbs.
	mm 50	179	152	16	4	19	121	51	76	51	229	-	4	12.7-330	82	16	25	16	58	10.0 kgs.
	in 2½	7 1/2	7	1 1/16	4	3/4	5 1/2	2 1/2	3 11/16	2	16	-	4	1/2-13UNC	4 1/8	3/4	1	3/4	2 15/16	34.0 lbs.
	mm 65	191	178	17	4	19	140	64	94	51	406	-	4	12.7-330	105	19	25	19	74	15.4 kgs.
	in 3	8	7 1/2	3/4	4	3/4	6	3	4	2 9/16	16	-	4	1/2-13UNC	4 1/8	3/4	1	3/4	2 15/16	38.0 lbs.
	mm 80	203	191	19	4	19	152	76	102	56	406	-	4	12.7-330	105	19	25	19	74	17.2 kgs.
G4000	in 4	9	9	1 5/16	8	3/4	7 1/2	4	4 13/16	2 9/16	19 11/16	-	4	1/2-13UNC	4 1/8	1 5/16	1 5/16	1 5/16	3 1/8	58.0 lbs.
	mm 100	229	229	24	8	19	191	102	122	56	500	-	4	12.7-330	105	24	24	24	79	26.3 kgs.
	in 6	10 1/2	11	1	8	7/8	9 1/2	6	7 3/16	3	26	-	4	5/8-11UNC	5 1/8	1 1/8	1 1/8	1 1/8	3 3/8	118.0 lbs.
	mm 150	267	279	25	8	22	241	152	183	76	660	-	4	15.8-279	130	28	28	28	92	53.5 kgs.
	in 8	11 1/2	13 1/2	11	8	-	-	8	10 1/4	20	11 3/4	7 7/8	4	3/4"-10UNC	7 1/16	1 1/16	3/8	1 3/4	5	600.0 lbs.
	mm 200	292	343	279	8	-	-	203	260	508	298	200	4	19.0-254	180	18	9	45	127	272.2 kgs.
in 10	13	16	11	12	-	-	10	11 11/16	20	11 3/4	7 7/8	4	7/8"-9UNC	7 1/16	1 1/16	3/8	1 3/4	5	1,125.0 lbs.	
mm 250	330	406	279	12	-	-	254	297	508	298	200	4	22.2-229	180	18	9	45	127	510.3 kgs.	

** Metric Dimensions are nominal pipe diameter. This product is produced with ASME/ANSI flanged end connections or DN flanged end connections.



A Watts Water Technologies Company

USA: Tel: (978) 689-6066 • Fax: (978) 975-8350 • Watts.com

Canada: Tel: (905) 332-4090 • Fax: (905) 332-7068 • Watts.com

Latin America: Tel: (52) 81-1001-8600 • Fax: (52) 81-8000-7091 • Watts.com

